

CATALOG NUMBERS:
P60-CACP-GFCI, P60-CACP-GFI-AL

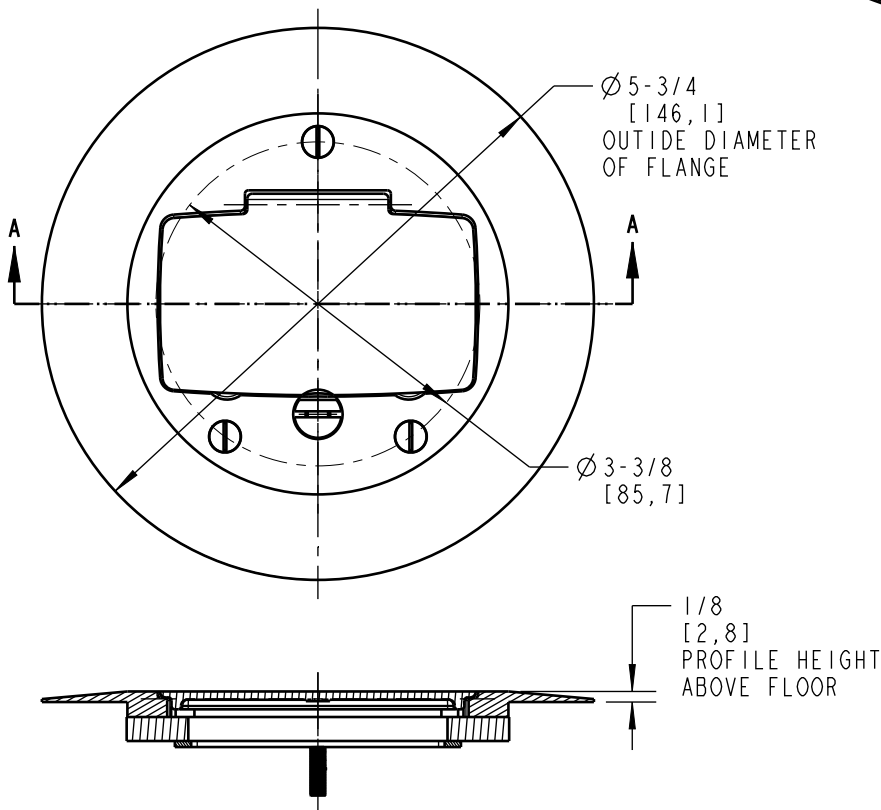
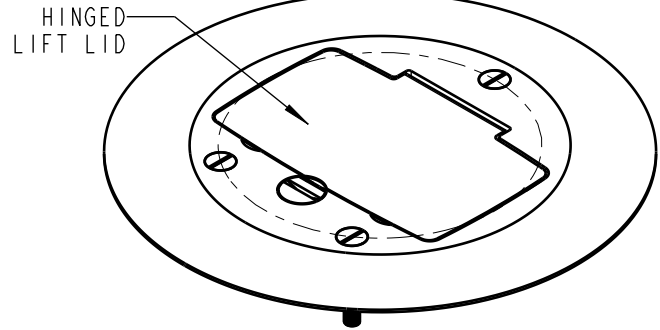

SECTION A-A

FEATURES:

1. INTEGRATED CARPET PLATE AND GFCI FLOOR PLATE IN ONE UNIT
2. FOR USE WITH 68P, 68 AND 600 SERIES FLOOR BOXES
2. AVAILABLE IN SOLID BRASS OR ALUMINUM MATERIAL
3. FURNISHED WITH SEALING GASKET AND MATCHING 8-32 X 1" SCREWS

| CATALOG NUMBERS | MATERIAL | FINISH |
|-----------------|-------------|----------|
| P60-CACP-GFCI | SOLID BRASS | BRASS |
| P60-CACP-GFI-AL | ALUMINUM | ALUMINUM |

GENERAL NOTES

1. ALL DIMENSIONS ARE FOR REFERENCE ONLY.
2. DIMENSIONS IN BRACKETS [] ARE IN METRIC UNITS.

REVISIONS

A SEE ECN (****) FOR APPROVAL SIGNATURES & RELEASE DATE.
 PROJECT NO: ****

DESCRIPTION:

**P60-CACP-GFCI, P60-CACP-GFI-AL
 CARPET PLATE, GFCI**

ORIGINAL PROJECT NO / ECN NO

003V001056 / ECN000083908

SHEET NO:

1 OF 1

REV. NO:

A

DRAWING NO:

WSD-002611

Thomas & Betts
 A Member of the ABB Group